



Manual Gun



- Always wear personal protective equipment (goggles, gloves, etc.) to protect yourself from sulfuric acid when filling batteries.
- Only water after charging.
- Read instructions in entirety before beginning the installation.

Installation Instructions:

1. Attach the quick-connect fitting and the gun to your 1/2" (12.5 mm) water hose.
2. Turn on the water supply. If using a watering cart with the manual gun, turn it on.
3. Squeeze the trigger to clear the hose of any air, dispensing water back in to a tank or sink. Continue until all air in the hose has been cleared and the water flow is uniform.

Note:

The manual gun has been pre-set to work with most battery vent caps. Standard vent caps must be removed before watering. If using flip top vent caps, they do not need to be removed. Flip open the cap lid to fill cells.

Operation:

1. If needed, adjust the level control collar. This sets the shut off level (a) of the gun within the cell. The control collar is adjustable using a 7/64" (2.78 mm) Allen wrench.
2. Turn on the water supply.
3. If batteries aren't watered on a regular schedule or if a dedicated filling hose is not being used, step 3 in the installation instructions will need to be repeated.
4. Insert the nozzle into the battery cell to be filled.

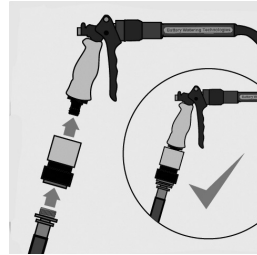

Connect

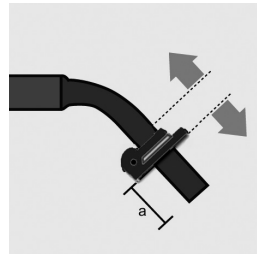

Adjust collar

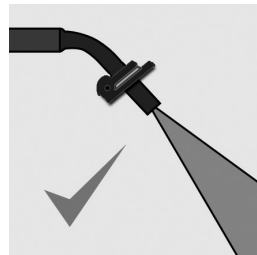

Clear hose of air

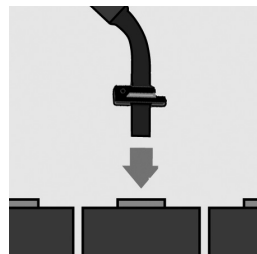

Insert nozzle

5. Squeeze the trigger until the cell is filled and shut-off takes place.
6. Gently tap the nozzle to prevent any drips.*
7. Remove the gun from the battery.
8. When watering is complete, turn off the water supply.

* After use, the gun may drip a little water. This is expected and necessary for the automatic resetting feature.



Tap nozzle

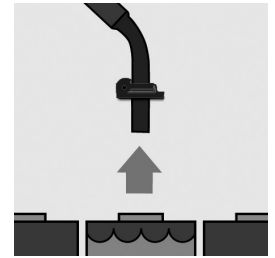

Remove nozzle

Warranty

This product is warranted against defects in workmanship and materials for a period of one year from date of shipment.

P: 336-714-0448
 F: 336-714-0449
 T: 877-522-5431
 www.batterywatering.com
 PAKA677_INSES_0316

